

# ALUMINUM ELECTROLYTIC CAPACITORS

## LP series 85°C 2000HR

- High Ripple Current And Low Impedance
- Used in Switch Power Supply, Smoothing Circuits.  
AD Adapter, Inverter Lighting System.

### SPECIFICATIONS

Item	Performance Characteristics									
Operating Temperature Range	-25°C ~ +85°C (200~450V).									
Rated Voltage Range	160~450W.V									
Capacitance Range	68~2200uF									
Capacitance Tolerance	±20% (120Hz, +20°C)									
Leakage Current (MAX)	$I \leq 3\sqrt{CV}$ After 5 minutes with rated working voltage applied at +20°C Where: C : Nominal capacitance in uF    V : Rated voltage in V									
Dissipation Factor (tan δ)	<table border="1"> <tr> <td>Rated voltage (V)</td> <td>160-400</td> <td>420 以上</td> </tr> <tr> <td>Tan δ (MAX)</td> <td>0.15</td> <td>0.20</td> </tr> </table> (120HZ/ +20°C)	Rated voltage (V)	160-400	420 以上	Tan δ (MAX)	0.15	0.20			
Rated voltage (V)	160-400	420 以上								
Tan δ (MAX)	0.15	0.20								
Low Temperature Stability Impedance Ratio	Impedance ratio at 120Hz <table border="1"> <tr> <td>Rated Voltage (V)</td> <td>160-400</td> <td>450</td> </tr> <tr> <td>Z(-25°C)/Z(+20°C)</td> <td>4</td> <td>8</td> </tr> <tr> <td>Z(-40°C)/Z(+20°C)</td> <td>-</td> <td>-</td> </tr> </table>	Rated Voltage (V)	160-400	450	Z(-25°C)/Z(+20°C)	4	8	Z(-40°C)/Z(+20°C)	-	-
Rated Voltage (V)	160-400	450								
Z(-25°C)/Z(+20°C)	4	8								
Z(-40°C)/Z(+20°C)	-	-								
Load Life	Application of rated voltage for 2000HR at 85°C, the capacitor shall meet the following limits. <table border="1"> <tr> <td>Capacitance Change</td> <td>≤ ±20% of the initial measured value</td> </tr> <tr> <td>tan δ</td> <td>≤ 200% of the initial specified value</td> </tr> <tr> <td>Leakage Current</td> <td>≤ The initial specified value</td> </tr> </table>	Capacitance Change	≤ ±20% of the initial measured value	tan δ	≤ 200% of the initial specified value	Leakage Current	≤ The initial specified value			
Capacitance Change	≤ ±20% of the initial measured value									
tan δ	≤ 200% of the initial specified value									
Leakage Current	≤ The initial specified value									
Shelf Life	After storage it for 1000HR at 85°C with no voltage applied. The capacitor shall meet the following limits. <table border="1"> <tr> <td>Capacitance Change</td> <td>≤ ±20% of the initial measured value</td> </tr> <tr> <td>tan δ</td> <td>≤ 200% of the initial specified value</td> </tr> <tr> <td>Leakage Current</td> <td>≤ The initial specified value</td> </tr> </table> Pre-treatment for measurements shall be conducted after application of dc working voltage for 30minutes.	Capacitance Change	≤ ±20% of the initial measured value	tan δ	≤ 200% of the initial specified value	Leakage Current	≤ The initial specified value			
Capacitance Change	≤ ±20% of the initial measured value									
tan δ	≤ 200% of the initial specified value									
Leakage Current	≤ The initial specified value									

### MULTIPLIER FOR RIPPLE CURRENT

#### Frequency coefficient

Freq(Hz) R.V(V)	50	120	1K	10K	50k-100K
160~250	0.80	1.00	1.35	1.45	1.50
315~450	0.80	1.00	1.30	1.41	1.45

### CATALOG NUMBERING SYSTEM (Example:400V 150uF)

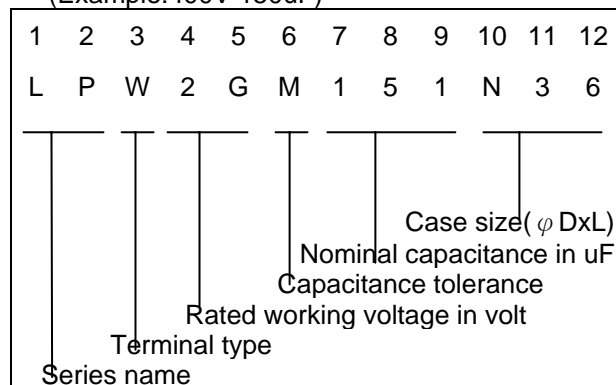

# ALUMINUM ELECTROLYTIC CAPACITORS

**LP series**      **85°C 2000HR**

**DIMENSIONS (mm)**

●TYPE. TB( $22 \leq D \leq 35$ )

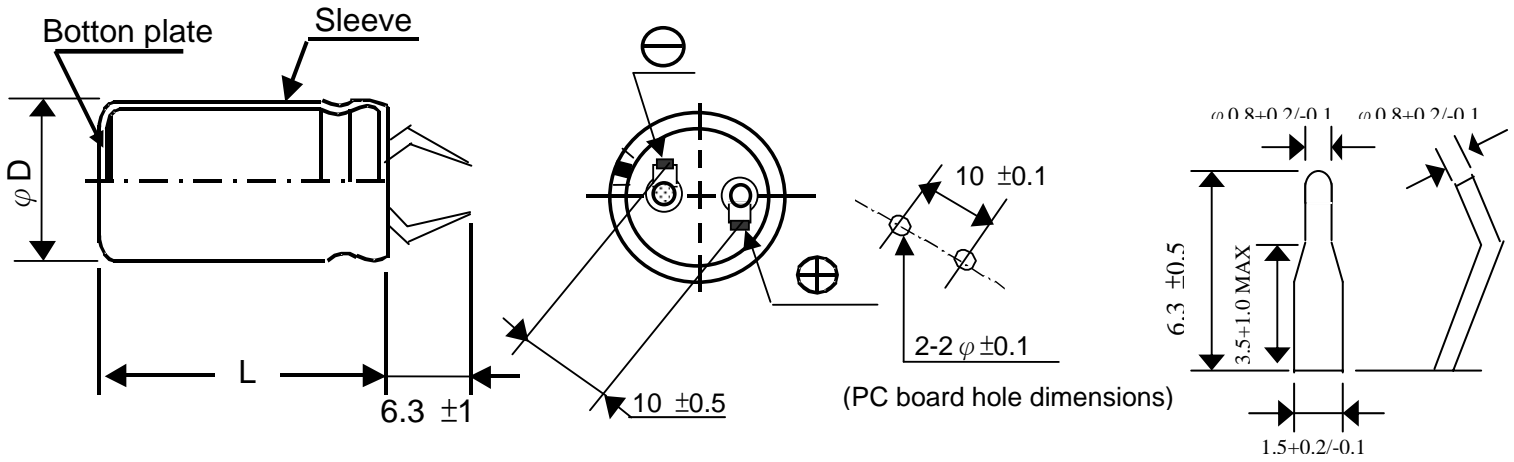

●TYPE. TC( $22 \leq D \leq 35$ )

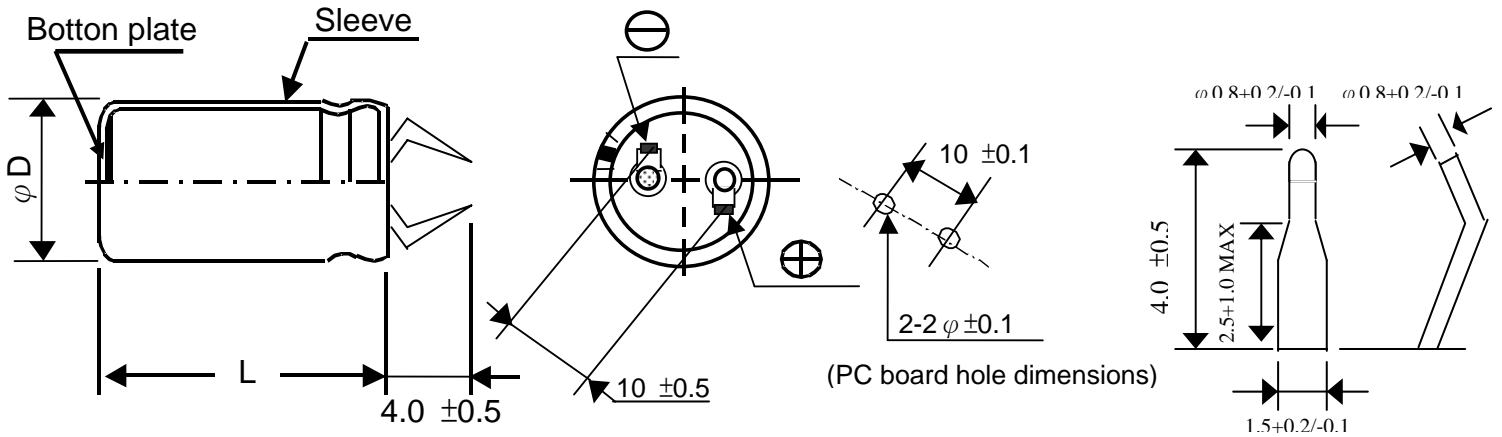

$\varphi D + 1.0$ MAX	22~35					
$L \pm 2.0$	25	30	35	40	45	50

# ALUMINUM ELECTROLYTIC CAPACITORS

**LP series 85°C 2000HR**

## STANDARD SIZES AND PERMISSIBLE RIPPLE CURRENT

Cap(uF) \ W.V		DxL(mm) Ripple Current (A 85°C,120Hz) r.m.s											
		200		220		250		400		420		450	
		2D		2B		2E		2G		2H		2W	
68	680							20x25	0.75	20x25	0.70	20x30	0.70
82	820							20x30	0.82	20x30	0.80	20x35	0.80
100	101							20x30 22x30	0.95 0.99	20x35 22x30	0.90 0.97	22x30	0.95
120	121							20x35 22x30	1.07 1.09	20x35 22x30	1.04 1.07	22x35 25x25	0.95 0.97
150	151							20x40 22x35	1.22 1.24	22x35	1.21	22x40 25x30	1.18 1.25
180	181					20x25	1.20	22x40	1.41	22x40	1.33	22x45	1.32
220	221	20x25	1.19	20x25	1.23	22x25	1.24	22x45 25x35	1.58 1.64	25x40	1.67	30x35	1.64
270	271	22x25	1.37	22x25	1.42	22x30	1.5	30x30	1.82	30x35	1.78	30x40	2.00
330	331	22x30	1.63	22x30	1.59	22x30 25x25	1.66 1.61	25x45 30x35	2.00 2.05	30x40	1.98	30x45	2.12
390	391	22x30	1.73	22x35	1.8	22x35	1.88	30x40 35x35	2.26 2.28	30x40	2.22	30x45	2.35
470	471	22x35	2.10	22x35	2.06	22x40	2.15	30x45 35x40	2.51 2.54	35x40	2.50	35x40	2.55
560	561	22x40	2.18	22x40	2.22	30x30	2.35	35x45	2.85	35x45	2.95	35x45	2.93
680	681	22x45	2.48	22x45	2.62	30x35	2.71	35x50	3.10				
820	821	22x50	2.81	30x35	2.84	30x35 35x30	2.98 2.96						
1000	102	25x45	3.28	25x50	3.53	30x45	3.56						
1200	122	25x50	3.61	30x45	3.72	30x50	3.99						
1500	152	30x50	4.13	35x40	4.10	35x45	4.33						
1800	182	35x45	4.59	35x45	4.52	35x50	4.54						
2200	222	35x50	5.25										